



Lufthansa
Aviation Training

Train smart. Fly safe.



Vienna. Your Training Guide.

Map

Lufthansa Aviation Training Center	3
------------------------------------	----------

Directions

By Aircraft	4
By Car	5
By Train and Bus	6
Train and Bus Schedule	7

Simulators

Overview	8
----------	----------

Floor Plans

Building 974 / Ground Floor	9
Building 974 / First Floor	10
Building 974 / Second Floor	11

Services

Services of Lufthansa Aviation Training	12
Business Services	14
Food and Beverages	15
Lockers, Parking, First Aid	16
Customer Satisfaction Management	17

The Vienna Aviation Campus is located in the immediate vicinity of Vienna International Airport, which, as Austria's largest commercial airport, is easily accessible by public transportation.



Directions / By Aircraft

Whether you arrive by air or come to the airport on a train or bus from Vienna, please take the "Airport Shuttle" bus (Terminal 3, arrivals, bus stop no. 1). The shuttle to the Training Center takes 10 minutes. Please get off at the Austrian Airlines (AUA) main entrance.

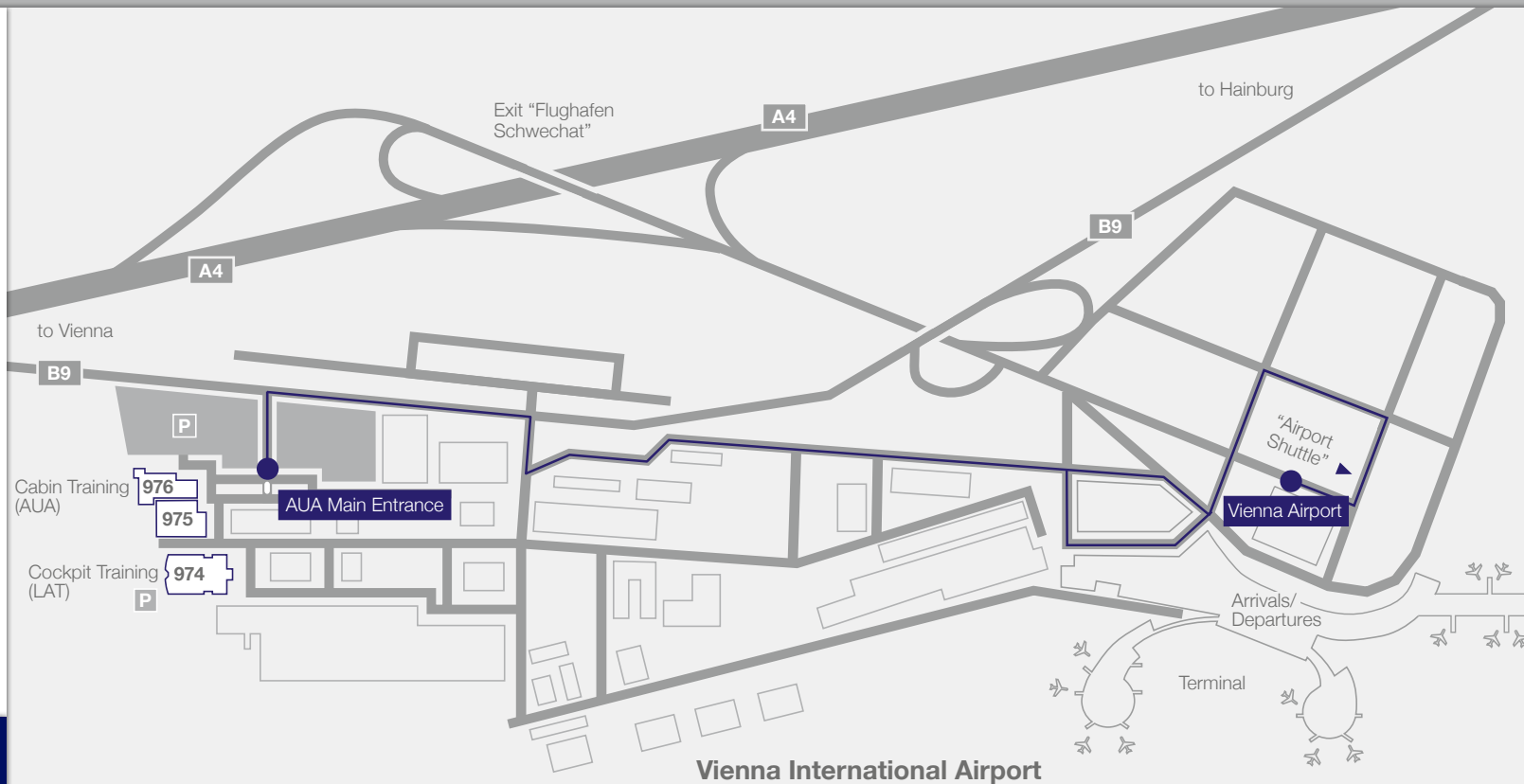

— By "Airport Shuttle"

More information:

- By Car** > 5
- By Train and Bus** > 6
- Bus Schedule** > 7

Directions / By Car

From Vienna, take the A4 motorway in direction to the airport. Leave the motorway at exit “Flughafen Wien Schwechat” and follow the signs in direction “Fischamend West/ Schwechat”. Take B9 road in direction “Schwechat” and exit at “Austrian Airlines Flughafen Basis”, which is next to a car park.



— By car

More information:

By Aircraft > 4

By Train and Bus > 6

Directions / By Train and Bus (external)

The City Airport Train (CAT) takes you directly from “Wien Mitte” to the airport every 30 minutes. Travel time is 16 minutes. The S7 suburban train from “Wien Mitte” takes 23 minutes. IC and RJ trains depart from “Meidling” every 30 minutes to the airport.

Various bus lines (Vienna Airport Lines) serving different points in Vienna take you directly to and from the airport.

- Train station
- - - By train
- Bus stop
- By bus

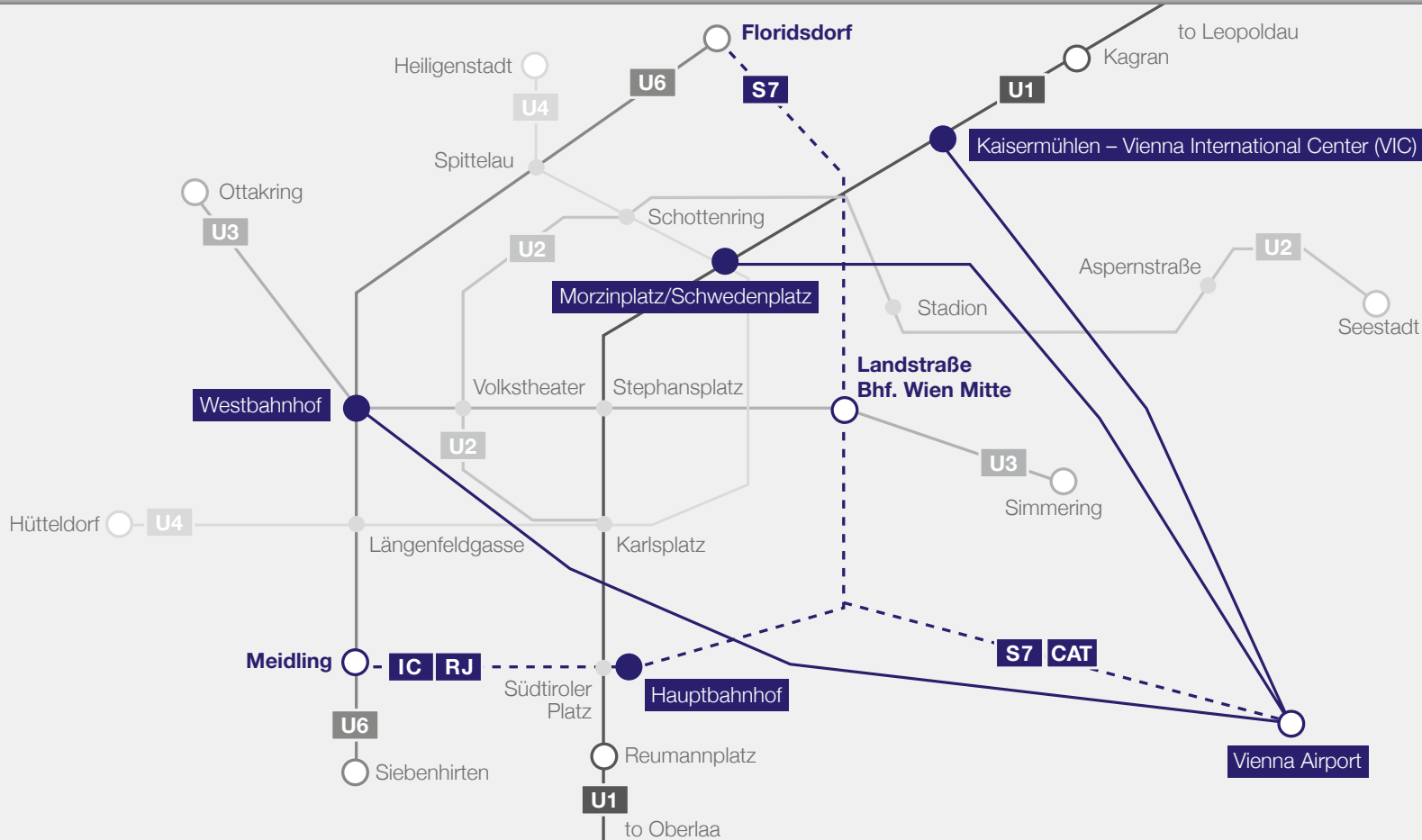

The departure and arrival times of the current schedules are posted at the stations.

From Vienna City to Lufthansa Aviation Training Center Vienna

S7 Wien City > Vienna Airport

04:19 Wien Mitte
 ↓
04:30–23:45
 every 30 min.
 ↓
04:42 Vienna Airport

CAT Wien City > Vienna Airport

05:37 Wien Mitte
 ↓
05:36–23:06
 every 30 min.
 ↓
05:53 Vienna Airport

Airport Shuttle Vienna Airport > AUA

05:30 Airport Arrival
 ↓
05:30–08:30 every 15 min.*
08:30–14:00 every 30 min.
14:00–16:00 every 15 min.*
16:00–23:30 every 30 min.
 ↓
05:43 AUA Main Entrance

From Lufthansa Aviation Training Center Vienna to Vienna City

Airport Shuttle* AUA > Vienna Airport

05:52 AUA Main Entrance
 ↓
05:52–23:52
 every 30 min.
 ↓
06:00 Vienna Airport

S7 Vienna Airport > Wien City

04:42 Vienna Airport
 ↓
04:53–00:17
 every 30 min.
 ↓
05:01 Wien Mitte

CAT Vienna Airport > Wien City

06:08 Vienna Airport
 ↓
06:06–23:36
 every 30 min.
 ↓
06:24 Wien Mitte

* From October to May: every 30 min.

Full-Flight Simulators Airbus

Airbus A320-200 (FT22)

Airbus A320-200 (FT53)

Airbus A320-200 (FT81)

Bldg. 974, First Floor > 10

Bldg. 974, First Floor > 10

Bldg. 974, First Floor > 10

Full-Flight Simulator Embraer

Embraer EMB-190 (FT64)

Bldg. 974, First Floor > 10

Full-Flight Simulator Bombardier

Dash 8-Q400 (FT54)

Bldg. 974, First Floor > 10

Flat Panel Trainer Airbus

Airbus A320 (PT04)

Bldg. 974, First Floor > 10

Flat Panel Trainer Embraer

Embraer EMB-190 (PT17)

Bldg. 974, First Floor > 10

Mock-up Airbus

Airbus A320

Bldg. 974, Ground Floor > 9

Mock-up Bombardier

Dash 8-Q400



Bldg. 974, Ground Floor > 9

Mock-up Embraer

Embraer EMB-190

Bldg. 974, Ground Floor > 9

To get to your simulator training from the Austrian Airlines main entrance, follow the directions to Building 974. The porter at the entrance will be happy to assist you.

- MU** Mock-up
- B** Briefing Room
-  Break Room
-  Lift
-  Restroom

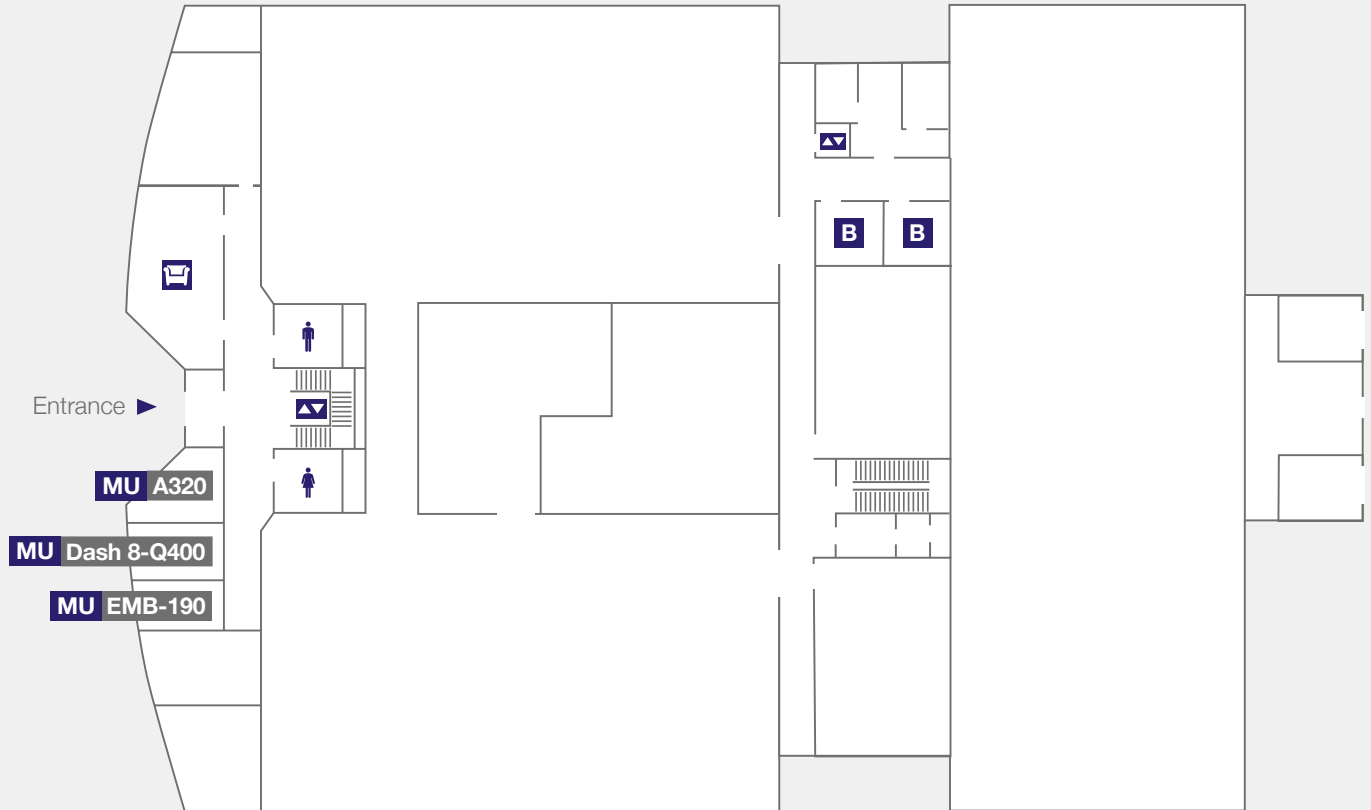



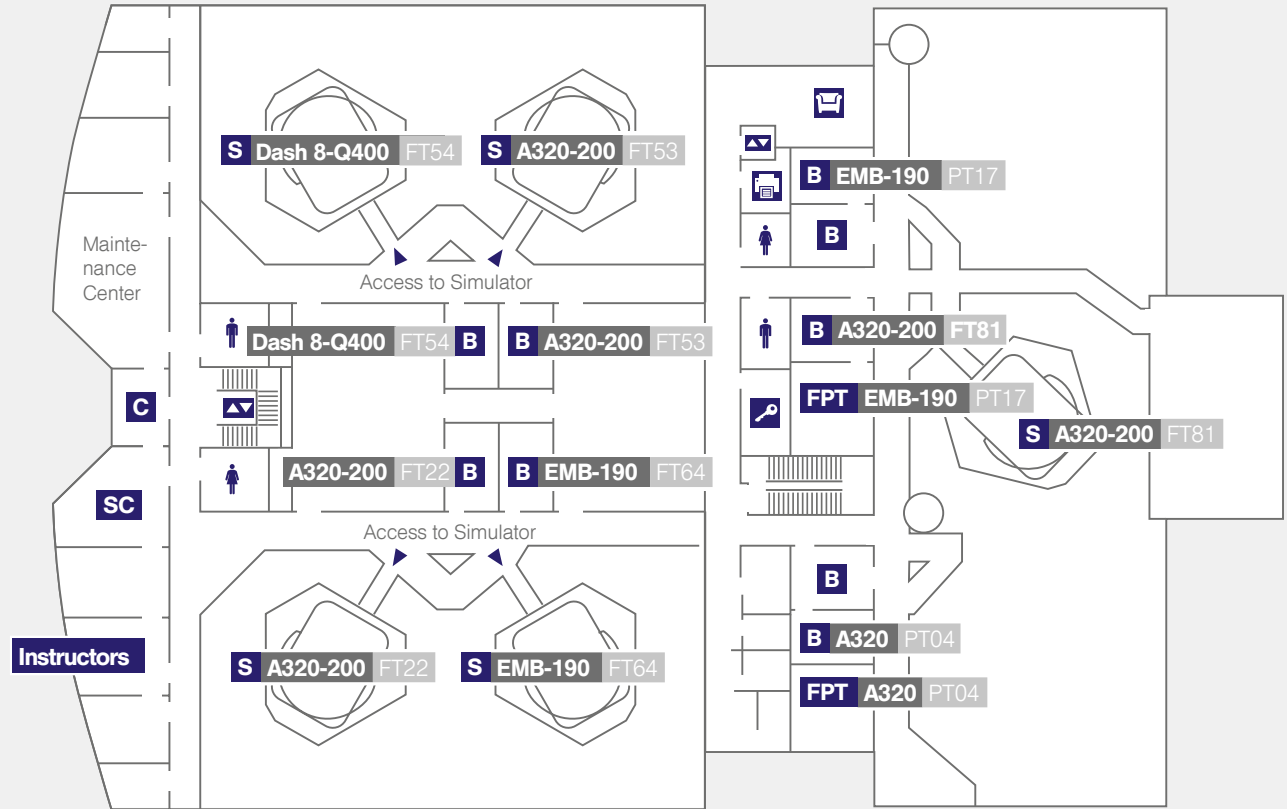

On the First Floor of the building, you'll find the Full-Flight Simulators and the Flat Panel Trainers. The Briefing Rooms can also be found on this level. You may use the lockers to securely store your luggage. The Break Room offers internet access as well as a place to relax during breaks.

- SC** Service Center
- S** Full-Flight Simulator
- FPT** Flat Panel Trainer
- B** Briefing Room
- C** Conference Room
- ▲▼** Lift
- ♂♀** Restroom
- 🔑** Lockers
- 📄** Break Room
- 📄** Copy Room



There are two conference rooms and two classrooms located on the Second Floor of the building.

-  Conference Room
-  Classroom
-  Lift
-  Restroom

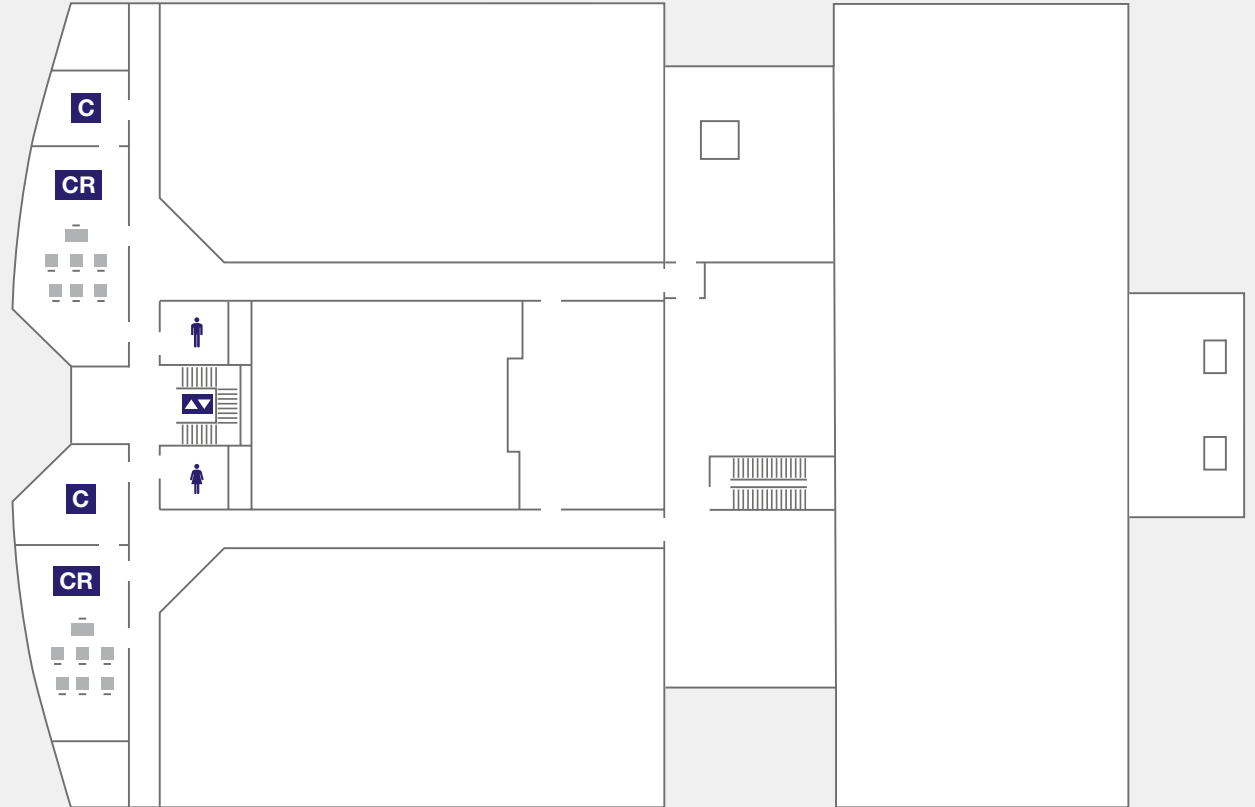

GROUP SERVICES OF LUFTHANSA AVIATION TRAINING

1/2

We are there for you: 24 hours a day, 7 days a week.

Phone: +49 (0)69 696 72 444

Fax: +49 (0)69 696 93 950

E-mail: info@lat.dlh.de

Lufthansa Aviation Training Center
Austrian Airlines Base, Bldg. 974
Administration, Room A.1.06, First Floor
1300 Vienna Airport

Phone: +43 51766-76613

E-mail: info@lat.dlh.de

Bldg. 974, First Floor > 10

ACCESS KEY CARD

2/2

Please obtain your SIM key card at the AUA Security, main entrance, 24 hours a day, 7 days a week.

For access to the simulators you have to register under the following link:
<http://eservices.lufthansa-aviation-training.com/web/eregistration/login>

INTERNET

Terminals with free internet access:

Break Room **Bldg. 974, Ground Floor** > 9

WLAN ZONES

All Rooms

COPY ROOM

Aisle between the two simulator halls **Bldg. 974, First Floor** > 10

FURTHER QUESTIONS

Please ask our colleagues at the Service Center or at Maintenance.

They will be glad to assist you.

Maintenance **Bldg. 974, First Floor** > 10

Service Center **Bldg. 974, First Floor** > 10

RESTAURANT

Our restaurant in Building 975 serves you lunch, snacks and a selection of beverages.

Opening hours: Mon–Fri 8:00 a.m.–3:30 p.m.

Lunch: 11:30 a.m.–2:00 p.m.

VENDING MACHINES

Snacks are available from the vending machines, 24 hours a day, 7 days a week.

Break Room Bldg. 974, First Floor > 9

Break Room Bldg. 974, First Floor > 10

LOCKERS

There are lockers available for your manuals.

Bldg. 974, First Floor > 10

PARKING

There are parking spaces in front of Building 974.

If these are full, please ask the porter at the Austrian Airlines main entrance for access to the Austrian Airlines parking lot next to Building 976.

Lufthansa Aviation Training Center > 3

FIRST AID

Trained first aid staff can be requested via the Maintenance.

Bldg. 974, First Floor > 10

WE VALUE YOUR FEEDBACK

1/2

As a company with a strong customer focus, we do everything we can to provide the finest service possible. Your suggestions or criticism can help us to improve. We look forward to receiving your comments via any of the channels listed below.

OUR STAFF

Our Service Center or Maintenance colleagues will be happy to receive your feedback and forward it to the right place. If you'd like to track your feedback's progress, please leave your contact data so we can respond.

eTLB SATISFACTION SURVEY

2/2

After your simulator session, a short satisfaction survey will appear on the display of your eTLB. This takes just two minutes to complete, and we would greatly appreciate your co-operation. You'll find an eTLB on every simulator.

E-MAIL AND CONTACT

Like to send feedback from outside the Training Center?

Please e-mail us at info@lat.dlh.de, or visit our website www.lufthansa-aviation-training.com and use the contact form in the contact area.



Lufthansa **Aviation Training**

Train smart. Fly safe.

Lufthansa Aviation Training Austria GmbH
Austrian Airlines Base, Building 974
1300 Vienna Airport
Austria
Phone: +43 51766-76613
E-mail: info@lat.dlh.de
www.lufthansa-aviation-training.com